



* Shown with optional strike zones and network display.

Features and Benefits

- **Stylish kiosk with curved front** creates appealing, custom branded ATM environment
- **Replaceable front ATM panel with recessed ATM opening** protects your ATM
- **Recessed based on front body panel** allows for vehicle bumper clearance
- **Patented Straight Line Suspension (SLS) System** distributes the ATM weight throughout the kiosk frame
- **Seamless, composite roof with internal drainage system** prevents leakage and eliminates unsightly streaking
- Includes **backlit front sign, envelope dispenser, and climate control system**
- Meets **seismic zone 4 requirements, wind shear 120 mph**, and is **UL-listed**
- Additional options include: **backlit approach sign, strike zones, waste receptacle**, and more...

Materials

Fiberglass composite shell
Fiberglass composite roof
Interior steel structure

Patent: US 6,457,277 B1

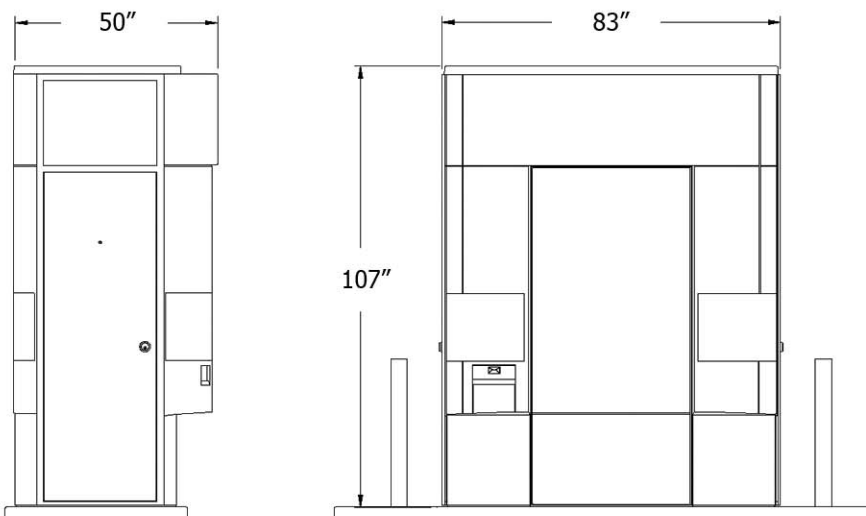

ATM Compatibility

Diebold
Opteva 740, 1073i, 1073ix, 1077ix

NCR
5688, 5887, 5888, 6634

Wincor Nixdorf
ProCash 2250, ProCash 2250xe

Nautilus Hyosung
Monimax 5100T, 7000D, 7600D

Tranax
MBS5000DR

Patent: US 6,457,277 B1