

57"



* Shown with optional network display and graphics panel.

Features and Benefits

- **Attractive surround** delivers effective ATM branding impact
- Includes **backlit front sign** for improved recognition and visibility
- **Task lighting** provides increased visibility for ATM customers
- Customer convenient **waste receptacle**
- **Integrated bumper guard** protects unit and adds additional visual element
- Offers **area for network affiliation display** and **graphics panel**

Materials

Fiberglass composite body
Interior mounting metal

Benefits of Fiberglass

- Damage resistant to extend product life and lower long-term maintenance costs
- Will not rust or corrode
- Use of molds ensures consistent product

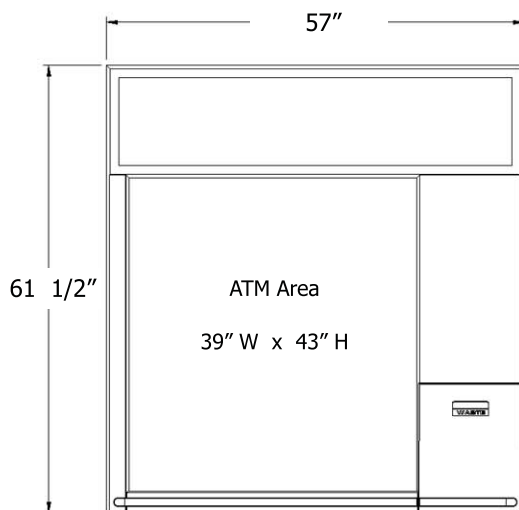

ATM Compatibility

Diebold

Opteva 740, 1073i, 1073ix, 1077ix

NCR

5688, 5886, 5887, 5888, 6634

Wincor Nixdorf

CSC 450, ProCash 2250, ProCash 2250xe

Nautilus Hyosung

Monimax 5100T, 700D, 7600D

Tranax

MBS5000DR, MBS5000DS

Triton

FT5000