

* 3131 shown with optional network display and graphics panel.

Features and Benefits

- **Simple design** allows for branding opportunities at a **low cost**
- Includes **backlit front sign** for improved branding and recognition
- **Task lighting** provides increased visibility for ATM customers
- Offers **area for network affiliation display** and **graphics panel**
- 3131-right side panel, 3132-left side panel

Materials

Fiberglass composite body
Interior mounting metal

Benefits of Fiberglass

- Damage resistant to extend product life and lower long-term maintenance costs
- Will not rust or corrode
- Use of molds ensures consistent product

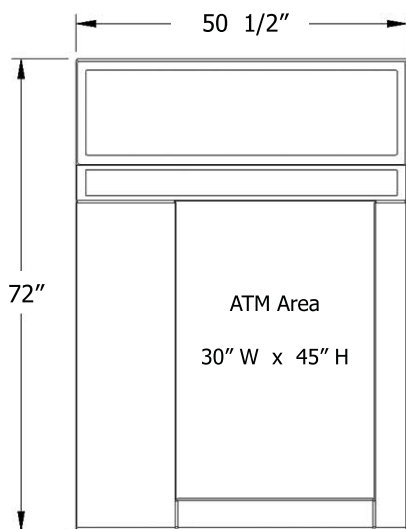

* 3132 shown with optional network display and graphics panel.

ATM Compatibility

Diebold

Opteva 500, 522, 560, 562, 760, 1064i, 1070i, 1071ix

NCR

5670, 5674, 5684, 5870, 5874, 5884, 5886, 5887, 6626

Wincor Nixdorf

ProCash 2150xe

Nautilus Hyosung

Monimax 5100T, 7000T

Tranax

MBS5000W, Mini-Bank 2100T

Triton

RT2000, FT5000