



* Shown with optional camera window and network display.

Features and Benefits

- **Tall topper** increases ATM visibility and improves recognition
- Includes **backlit front sign** for improved branding and identification
- Easily accessible, **secure storage area**
- Offers **area for network affiliation display** or **graphics panel**
- **Optional camera window** for your security cameras
- **Optional cord chase**

Materials

Thermoformed plastic

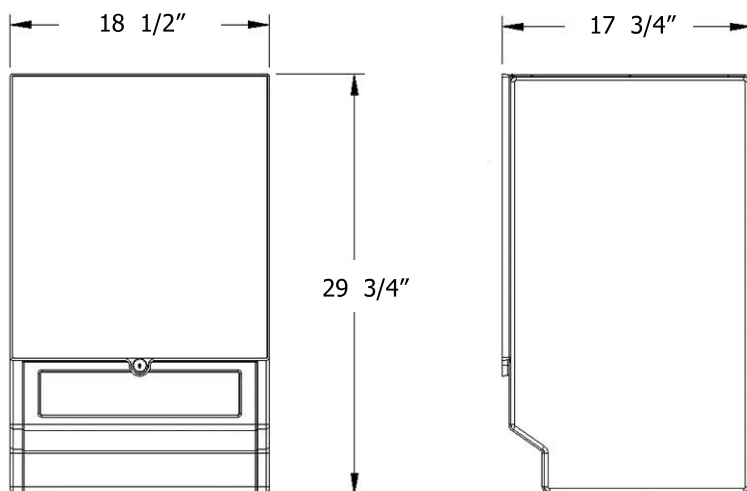

ATM Compatibility

Diebold

Opteva 520, 1063ix, 1064i, 1064ix

NCR

5670, 5870, 5877, 6622, EP62

Wincor Nixdorf

ProCash 1500, ProCash 1500xe

Nautilus Hyosung

Monimax 5100